

**Visiting Choa Chu Kang Columbarium and Choa Chu Kang Cemetery
between 21 March 2026 and 19 April 2026**

From Sat 21 March 2026 to Sun 19 April 2026, Choa Chu Kang Cemetery and Columbarium will be opened 24 hours daily. Please exercise care and caution, especially if you are planning to visit at night.

Choa Chu Kang Columbarium (CCKC)

We wish to share that there are ongoing works at the columbarium. Members of the public can continue to access all occupied niches in the columbarium. Visitors are reminded to exercise care and caution especially if you are planning to visit at night and keep away from hoarded areas. Safety at our facilities is of utmost importance to NEA. We apologise for any inconvenience caused and thank you for your kind understanding.

Getting there

By car	<p>If you intend to drive and park in Choa Chu Kang Columbarium, please book an e-appointment (in 2-hours intervals) at go.gov.sg/qm2026cckc when visiting between <u>6.00am and 4.00pm</u> on:</p> <ul style="list-style-type: none">• Good Friday - <u>Fri 3 April 2026</u>• Weekends between Sat 21 March 2026 and Sun 19 April 2026 - <u>21, 22, 28, 29 March</u>; and <u>4, 5, 11, 12, 18, 19 April</u>) <p>If you are visiting outside of the above-mentioned dates and timings, there is no need for any bookings.</p> <p>You are required to show proof of your successful e-appointment booking to traffic wardens before you can park your vehicle. This can be in the form of a confirmation email or using your NRIC.</p> <p>Vehicles exceeding 2,500kg unladen weight will not be allowed entry. This includes large buses or coaches or trucks.</p> <p>Vehicles accessing Choa Chu Kang Columbarium are required to follow this designated route: from Old Choa Chu Kang Road, enter via Cemetery Central Street 25, then proceed along Cemetery Central Street 4, Cemetery Central Street 15, and Cemetery Central Street 12 to reach the screening point. Entry via Chinese Cemetery Path 4 will be closed to all vehicles except NEA shuttle buses, authorised vehicles and emergency vehicles. Traffic wardens will be stationed along the route to provide directional assistance.</p>
--------	---

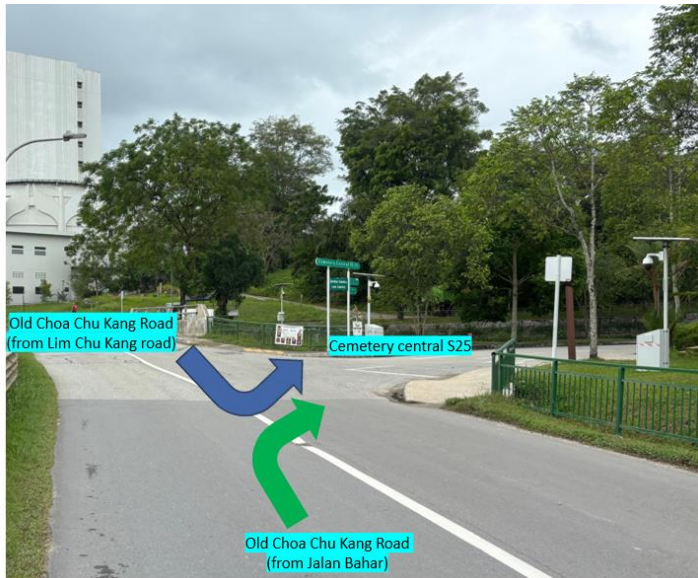

By taxis and private hire cars

Drop-off point: Carpark E outside Choa Chu Kang Columbarium.
 Pick-up point: Tent outside main entrance of Choa Chu Kang Columbarium.
 No e-appointment is required.

By bus

Bus Service	Nearest Bus Interchange	Operating Hours
172, 405 (Bus service 405 is available only during peak period)	Boon Lay Bus Interchange	https://www.smrt.com.sg/
975	Choa Chu Kang MRT station/ Bus stop at Choa Chu Kang Ave 4 opposite Lot 1 shopping mall	

By free shuttle bus

Shuttle buses are available from Yew Tee MRT station 30 mins interval to Choa Chu Kang Columbarium (15 mins interval during peak hours between 9am to 2pm).

Pick-up and drop-off points	Operation dates	Bus operation hours
-----------------------------	-----------------	---------------------

	<p>Yew Tee MRT station Exit C Bus Stop No.45321</p> <p>Choa Chu Kang Columbarium (51 Chinese Cemetery Path 4)</p>	<ul style="list-style-type: none"> • Good Friday Fri 3 April • Weekends between Sat 21 March and Sun 19 April 	<p>Between Yew Tee MRT Station and Choa Chu Kang Columbarium</p> <ul style="list-style-type: none"> • 1st bus at 7am at both locations • Last bus at 5pm at both locations • Shuttle bus operates at 30-min intervals during non-peak hours • Shuttle bus operates at 15-min intervals during peak hours from 9am to 2pm.
--	---	---	---

Choa Chu Kang Cemetery

Realignment of Lim Chu Kang Road

Visitors to Choa Chu Kang Cemetery and Choa Chu Kang Columbarium should note that Lim Chu Kang has been realigned from Jalan Bahar to a new junction with Old Choa Chu Kang Road. Bus services 172, 405, and 975 have also been rerouted, with new and existing bus stops relocated along the realigned roads. Visitors are advised to allow extra travel time to familiarise themselves with the new road layout and updated bus stop locations and to check the route information before travelling.

Map of Realigned Lim Chu Kang Road

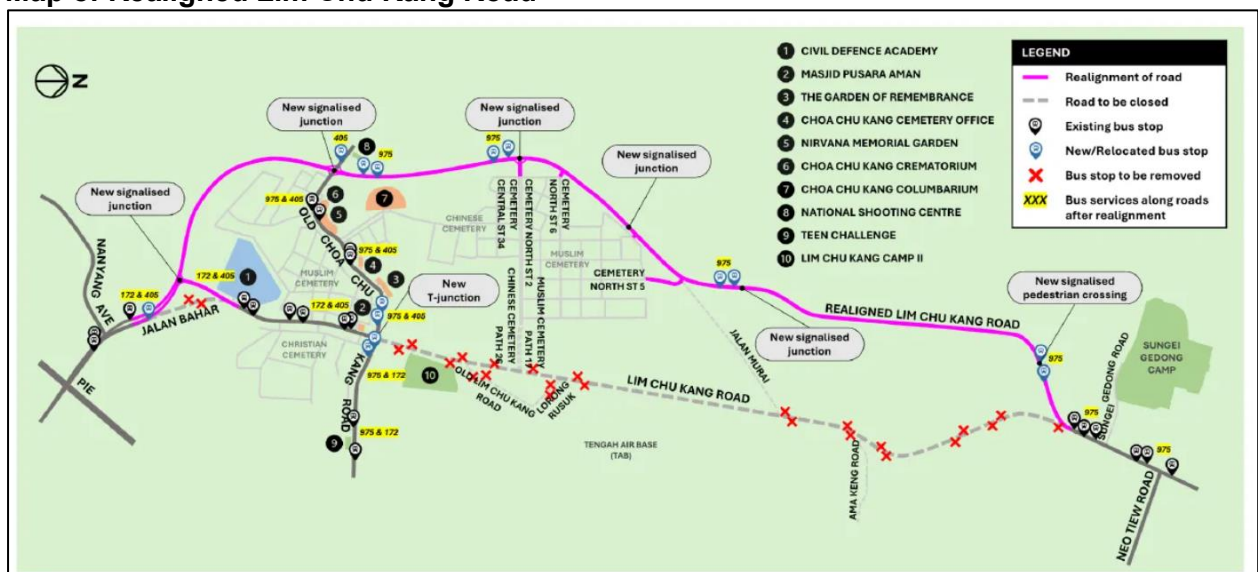

Third-party Grave Maintenance Services

- NEA provides regular grass-cutting maintenance for common areas of Choa Chu Kang Cemetery without additional charge. However, this service is not provided at individual graves and their monuments.
- Visitors may be approached by individuals at Choa Chu Kang Cemetery for payment of grave maintenance service fees. These services are not regulated or endorsed by NEA. If you did not make prior private arrangements for such services, please do not pay anyone who claims to have maintained the graves of your loved ones.
- NEA has reminded third-party grave maintenance service providers not to engage in any illegal activities, such as touting, extortion, harassment, and cheating. You may lodge a police report or contact us at 6225 5632 should you encounter any such incident.

Exercising Care around the Cemetery

- Visitors are reminded to exercise care and caution, by donning protective footwear and watching out for potholes, cracks, uneven or rough surfaces on pathways or terrain, when navigating or walking within the Choa Chu Kang Cemetery compound.
- Visitors are advised to check the weather forecast before visiting. In the event of thunderstorms with potential lightning risk during your visit, please seek shelter at the nearby pavilions or amenity blocks immediately.

Phase 9 Exhumation Programme

- The affected graves are located at Block 3A, 3B, 3C, 3D, 3E, 14E, 14F, 14G, 17, 18 and 19 within the Chinese Cemetery. The registration for claims will close on 30 April 2026
- For more information, please refer to the following link - Choa Chu Kang Cemetery Exhumation (Phase 9)
- Visitors should be aware that individuals may approach them offering exhumation services. These services are not regulated or endorsed by NEA. You may lodge a police report or contact us at 6225 5632 should you encounter any illegal activities such as touting or harassment.

Location Map of Choa Chu Kang Cemetery and Columbarium

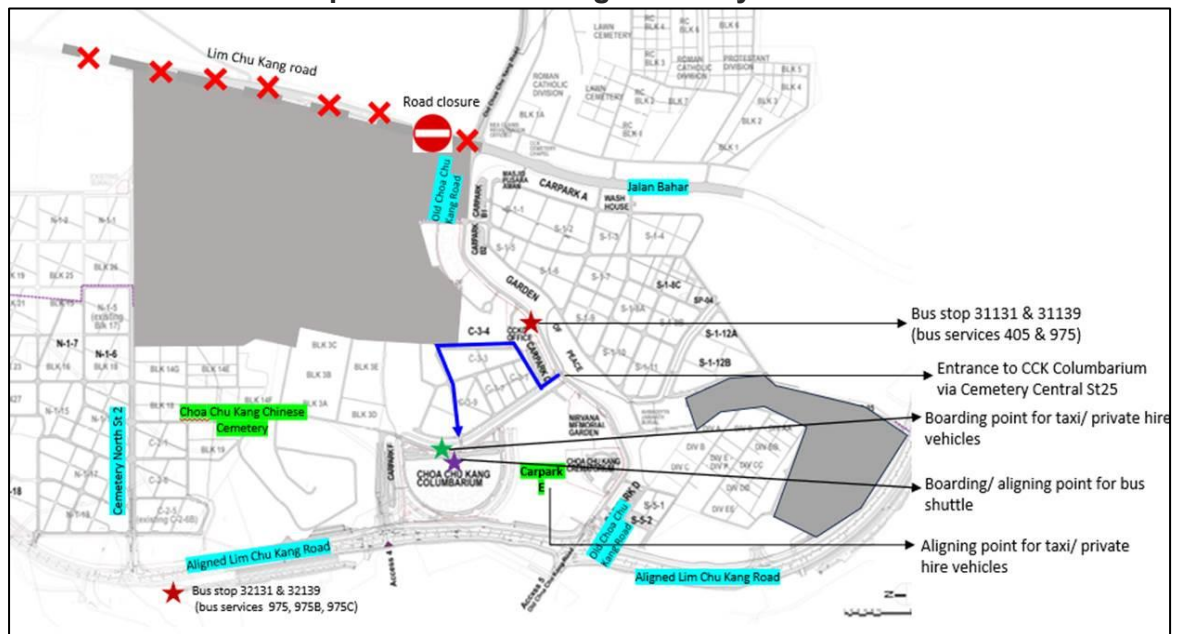

For Enquiries

Facility	Contact number	Operating hours
NEA Contact Centre	6225 5632	24 hours
Choa Chu Kang Cemetery Office	6795 9731	8.30am to 4.30pm (Mondays to Fridays) Closed for lunch from 1pm to 2pm
Phase 9 exhumation programme related enquiries	Email: nea_cckexhumation@nea.gov.sg Tel No.: 6795 5511	Mondays to Fridays: 8:30am to 4:30pm (Excluding Saturdays, Sundays & Public Holidays)